

# Dexter 580

Operating Manual





## CONTENTS

Introduction .....	Page 5
Passenger transport .....	Page 9
Rights and duties .....	Page 11
Water system .....	Page 13
Gas system .....	Page 21
Electric system .....	Page 25
Heating system .....	Page 33
Toilet .....	Page 37
Electrical appliances .....	Page 43
Openings .....	Page 49
Shut-down in winter .....	Page 55
Maintenance .....	Page 61
Miscellaneous and accessories .....	Page 65
Troubleshooting .....	Page 71

*Provisional illustrations*







# INTRODUCTION

Dear customer,

We would like to thank you for your trust in the **Karmann-Mobil** brand, which you have demonstrated by buying your recreational vehicle.

Many years of experience and know-how form the basis of this unique concept of a vehicle, which is positioned between an everyday vehicle and a motorcaravan.

Your smart and compact vehicle from **Karmann-Mobil** offers an especially ingenious interior and will serve you very well on short and long journeys alike.

In this operating manual you will find tips and information from **Karmann-Mobil** concerning the everyday care and maintenance of your vehicle so that you can enjoy all its advantages.

***Karmann-Mobil wishes you safe and pleasant travel at all times.***

# 1 – Usage instructions

---

These instructions will help you to become more familiar with your vehicle. Please read them thoroughly before using the vehicle for the first time.

These instructions provide you answers to almost all questions regarding the operation of a system or a device. It is therefore important to always keep these instructions on board of the vehicle.

The icons used in these instructions will help you to easily identify the location of each individual element. Some icons indicate the importance of the corresponding information:



**“Attention” icon:** Highlights an important point that must be observed.



**“Injury” icon:** Warns of a possible injury if the corresponding information is ignored.



**“Customer service” icon:** If you cannot find a solution for your problem in these instructions or in the instructions of the corresponding appliance manufacturer, please consult the customer service of your authorised dealer.



**“Contamination” icon:** Warns of possible environment pollution if the corresponding information is ignored.

With the delivery of your vehicle from **Karmann-Mobil** you also received a package.

In this package you will find instructions for all parts of the electric appliances from the respective manufacturer.

Make sure to read these instructions prior to use of your vehicle. The information contained in these instructions take precedence over the information provided in this operating manual.



## 2 – Warranty leaflet

---

To activate the warranty, the warranty certificate must be registered by the delivering dealer on the Eura Mobil Portal.



In connection to it, copy of the initial registration must be uploaded in the system. Through these actions the basic vehicle is registered for warranty coverage with the chassis manufacturer.

According to the Data Protection Act, a data protection declaration must be filled out and signed by the customer.





# PASSENGER TRANSPORT

## 1 – Seatbelt usage

---

Your vehicle is equipped with a certain number of seats for travelling. This number of seats is specified in the vehicle registration card. These seats are identified by icons on each bench. The passengers must use the identified seats during travelling. The seatbelts must be placed and fastened on both the seats facing the direction of travel and facing away from the direction of travel.



**Seats with a “red prohibition bar” icon must not be used while the vehicle is in motion.**





Seat facing the direction of travel and facing away from the direction of travel, equipped with three-point seat belt. **OBLIGATORY USE OF SEAT BELTS**



The equipment and appliances in the living room of the motorcaravan may only be used while the vehicle is standing still.

Their use during travel could violate the applicable road traffic regulations and poses risks the user must be aware of. No insurance cover!

**The manufacturer does not assume liability for events or accidents that occur while travelling.**



**When rearranging the seat cushions (especially when building the bed), make sure that both the belts and the belt buckles are correctly positioned for the next journey.**



# RIGHTS AND DUTIES



Waste water can only be drained at dedicated locations like roadside service areas, waste disposal stations or public and private sanitary facilities.



Attention: Public storm sewers must not be used for drainage as they are not designed to clean waste water.

All water drain valves must be kept closed while driving.



Household waste must be collected in bags and disposed of at the dedicated facilities.

**The application of all these principles strengthens mutual respect, respect for the environment and hospitality in the regions visited.**

*Charta des S.I.C.V.E.R.L (Syndicat des Véhicules de loisirs – Verband der Hersteller von Freizeitfahrzeugen – Association of manufacturers of leisure vehicles) and the C.L.C. (Comité de Liaison du Camping-car – Beratungsgremium Wohnmobile – Advisory Body Motorhomes).*



# WATER SYSTEM



# 1 – Water circuit

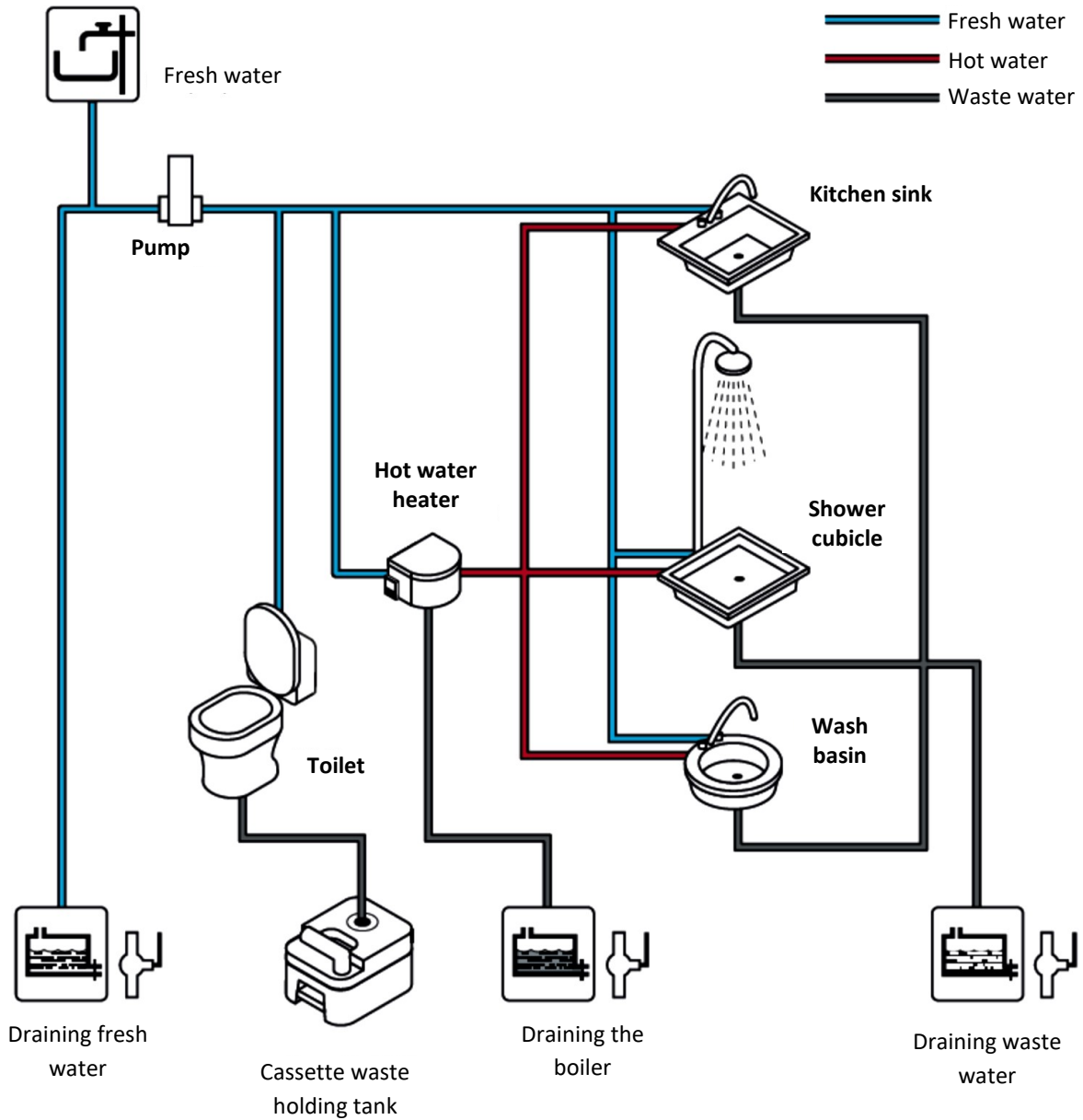

Waste water must only be drained at locations which are fully equipped for this purpose (caravan parks, waste disposal stations, etc.).

# 2 – Drinking water supply

Your mobile home is equipped with a permanent fresh water tank with a capacity of 105 l. It is located underneath the seat bench.

In winter, this tank remains free of ice as long as the motorcaravan is heated. It can be drained via a manual drain valve.

The fresh water level sensor measures the amount of water inside the tank. The control panel shows the filling level in percent.



The fresh water tank is filled by a hose without a connection piece via the plug on the front left side of the vehicle. The tank is full when water runs through the overflow and drips down to the ground.

To make sure that the tank is not filled completely, check the filling level on the control panel in test mode.



**!** The fresh water tank must only be filled with potable water.

**!** Before you open the stopcock and thus start the electric pump, you should check whether the tank holds any water. Running without water may damage the pump.

**!** Regardless of the source, depending on the filling system and the residual water in the tank, it cannot be guaranteed that the water is potable.

**!** The water in the tank loses its hygienic properties after a few days, even if additives are added. Drinking the water or using it for cooking is not recommended. The water should be changed frequently. This can be done at the lower right side. First, the tank must be cleaned with a disinfectant: the water in the fresh water tank is not to be considered potable.

## 3 – Pump and filter

The electric power supply for the pump is switched on from the control panel (see diagram). The pump supplies all water and sanitary connections of the vehicle and starts when a stopcock is opened.

The pump is located in the storage space of the front bench.

The pump filter is cleaned by your authorized dealer during the vehicle inspection.



Filter Pump

# 4 – Draining the fresh water

Turn off the power at the control panel.

Open the fresh water drain valve. The drain valve is located in the front storage space that can be accessed through the flap under the table.

Open all taps to ensure complete drainage.  
To finish the draining process, start the pump and let it run for some time, keeping the taps open during this time.



Fresh water drain valve

# 5 – Hot water



Your vehicle is equipped with a TRUMA D4 unit, a heater with integrated boiler, which is located in the rear box on the left side and powered with diesel fuel (unless, however, the vehicle is equipped with a gas option).

The system draws water directly from the fresh water tank and supplies various water extraction points (shower, wash basin, kitchen sink) with hot water.

• Control panel

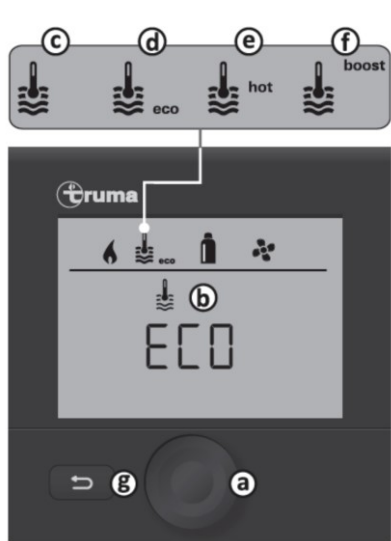

- Press the rotary/pressure switch **a** to activate the control panel.
- Scroll through the menu and select the hot water symbol **b**.
- Scroll through the available setting options and select the desired operating mode.
- c Boiler** - the hot water supply is active
- d Eco** - the hot water temperature is 40 °C
- e Hot** - the hot water temperature is 60 °C
- f Boost** - not available with Combi Diesel.

Press the rotary/pressure switch **a** to confirm your selection.  
Press the return button **g** to exit the menu.

- **Filling the boiler**

The entire water supply system must be rinsed with clean water before first use.



Check whether the rotary knob of the drain valve (Frost Control), which is located in the rear left-hand box, is in the "Operation" position, i.e. parallel to the water connection, and whether it is engaged. In order to close the drain valve, activate the pressure switch until it locks into place.

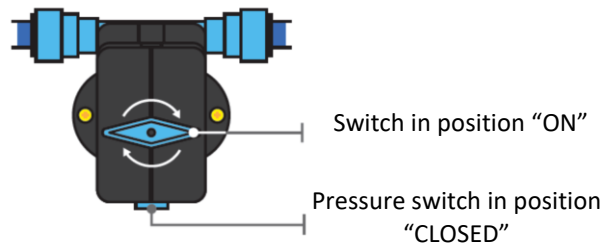

Turn on the pump at the control panel.

Open the hot water taps in the kitchen and bathroom. Leave the taps open until the air has escaped from the system and the water runs as a continuous stream from the taps.



*Control button to switch on the electric power supply for the pump*



If the temperature on the Frost Control is below 7°C, first start the heating system to warm up the rebound space and the Frost Control. As long as the temperature at the Frost Control is above 7°C, the drain valve can be closed.

- **Draining the boiler**



If the boiler is not used for an extended period of time, it must be emptied completely in order to avoid frost damage.

Turn off the pump on the control panel and open all hot water taps.

Turn the rotary knob of the drain valve (Frost Control) by 90° until it clicks into place. The pressure switch is released from the engaged position and the drain valve opens.

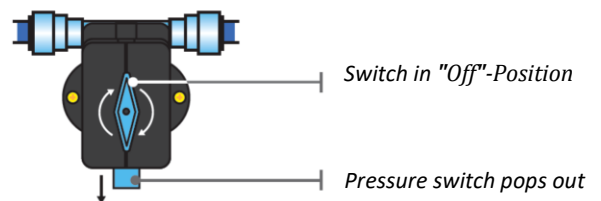



The water from the boiler is now drained outside via the drain valve. Place a container under the outlet to ensure that the boiler has been completely emptied (about 10 litres).



If the temperatures drop below 3°C, the Frost Control safety/drain valve opens automatically and empties the boiler.



Waste water can only be drained at dedicated locations like roadside service areas, waste disposal stations or public and private sanitary facilities.

## 6 – Kitchen sink and wash basin

---

The kitchen sink and wash basin are made of plastic and must be cleaned with suitable household products.



## 7 – Shower cubicle

---

The shower cubicle is equipped with a mixer tap. The sink must be cleaned regularly with a suitable household product. Do not forget to secure the shower head and the shower screen firmly in their holders before travelling. The shower screen is foldable and secured with a strap.



During the use of the shower, the floor grid must be placed on the floor of the shower cubicle and the shower curtain must be closed properly in order to prevent water from escaping.





The shower head provided in your vehicle can be attached to the outlet on the side of the left rear box and used as an outside shower.

## 8 — Draining

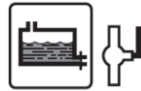

All waste water (from wash basin, kitchen sink and shower) is collected in a solid tank, which is located under the vehicle.

A sensor checks whether the tank is full; this is displayed by this light on the control panel: **R1**



When the control light comes on, the tank must be emptied as soon as possible.

In order to drain the waste water tank, it is sufficient to pull the lever on the left side of the vehicle near the rear wheel.

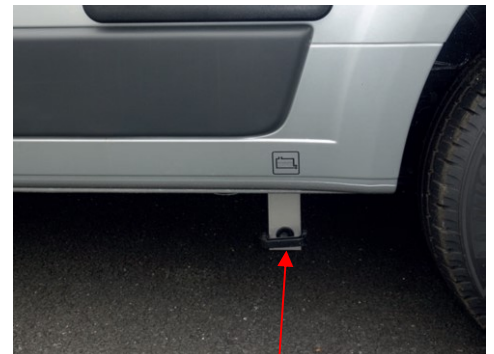

*Handle to drain the waste water tank*



Waste water can only be drained at dedicated locations like roadside service areas, waste disposal stations or public and private sanitary facilities.



**For safety reasons and to maintain the warranty, changes of the water system must only be made by authorised dealers with the written consent of Karmann-Mobil.**





# GAS SYSTEM



# 1 – Gas circuit

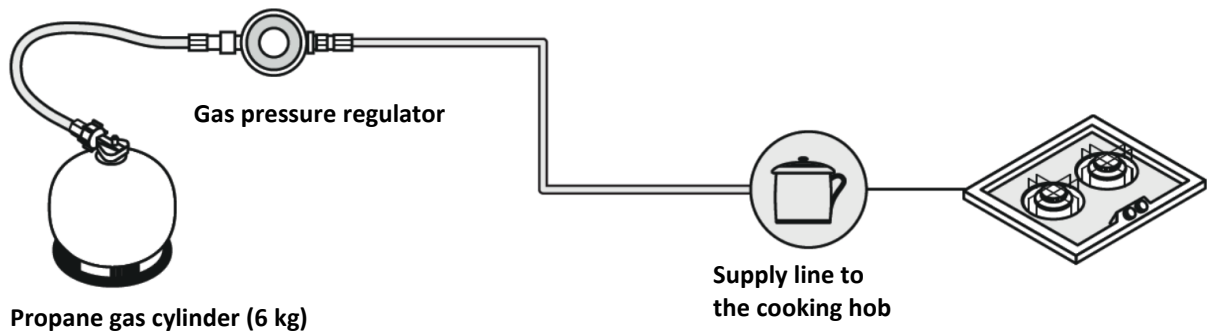

## 2 Commissioning

Your vehicle can hold two butane gas cylinders weighing 6 kg each (not included in the scope of delivery).

The cylinders can be placed in the left-side box in the rear storage room.

To gain access to the cylinder box, the door must be opened.

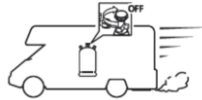

Connect the main stopcock to the top cylinder to put the system into operation.

The cylinders must be secured inside the gas box using the dedicated straps.

To replace an empty cylinder:

- Close the gas supply on the cylinder and disconnect the main stopcock.
- Replace the empty cylinder by a full one, then reconnect the main stopcock.
- Open the gas supply on the cylinder.

## 3 – Notes on safety

---



Any gas-powered appliances must only be used while the vehicle is parked (on a parking space).

Always close the gas supply from the cylinder before travelling.

Never block the safety ventilation, not even partially.

Additional ventilation is required when preparing food. Openings and skylights near the cooking hob must therefore be opened.

Never use a gas-powered appliance while the vehicle is parked inside a closed room (garage, tunnel, etc.) or in an explosive atmosphere (e.g. petrol station). Keep the gas supply from the cylinder closed during this time.

Do not use gas-powered appliances for purposes other than the ones they are intended for (e.g.: using the cooking hob for interior heating). Do not use appliances, which are connected inside, outside the vehicle.

The gas cylinders must be installed in the dedicated box. Never tilt a gas cylinder that is currently in use.

Do not subject the hose and its connections on the cylinder to tensile stress.

The gas cylinders must be used with butane gas only.

Never use an open flame to check for the presence of gas. If a gas leak is suspected, close the gas supply and contact your nearest authorised dealer.

Never smoke while changing a gas cylinder or when working in the vicinity of the gas box.

When changing the gas cylinder check the expiration date of the main stopcock.

Use a fire extinguisher to put out small fires (not included in the scope of delivery). Leave the vehicle and the surrounding area and make an emergency call.



It is absolutely necessary to carry out an annual inspection of the entire system by an expert specialist.

For this purpose please consult your authorised Karmann-Mobil dealer.



**For safety reasons and to maintain warranty, changes to the gas system must only be made by authorised dealers with the written consent of Karmann-Mobil.**





# ELECTRICAL SYSTEM

# 1 – Electric circuit

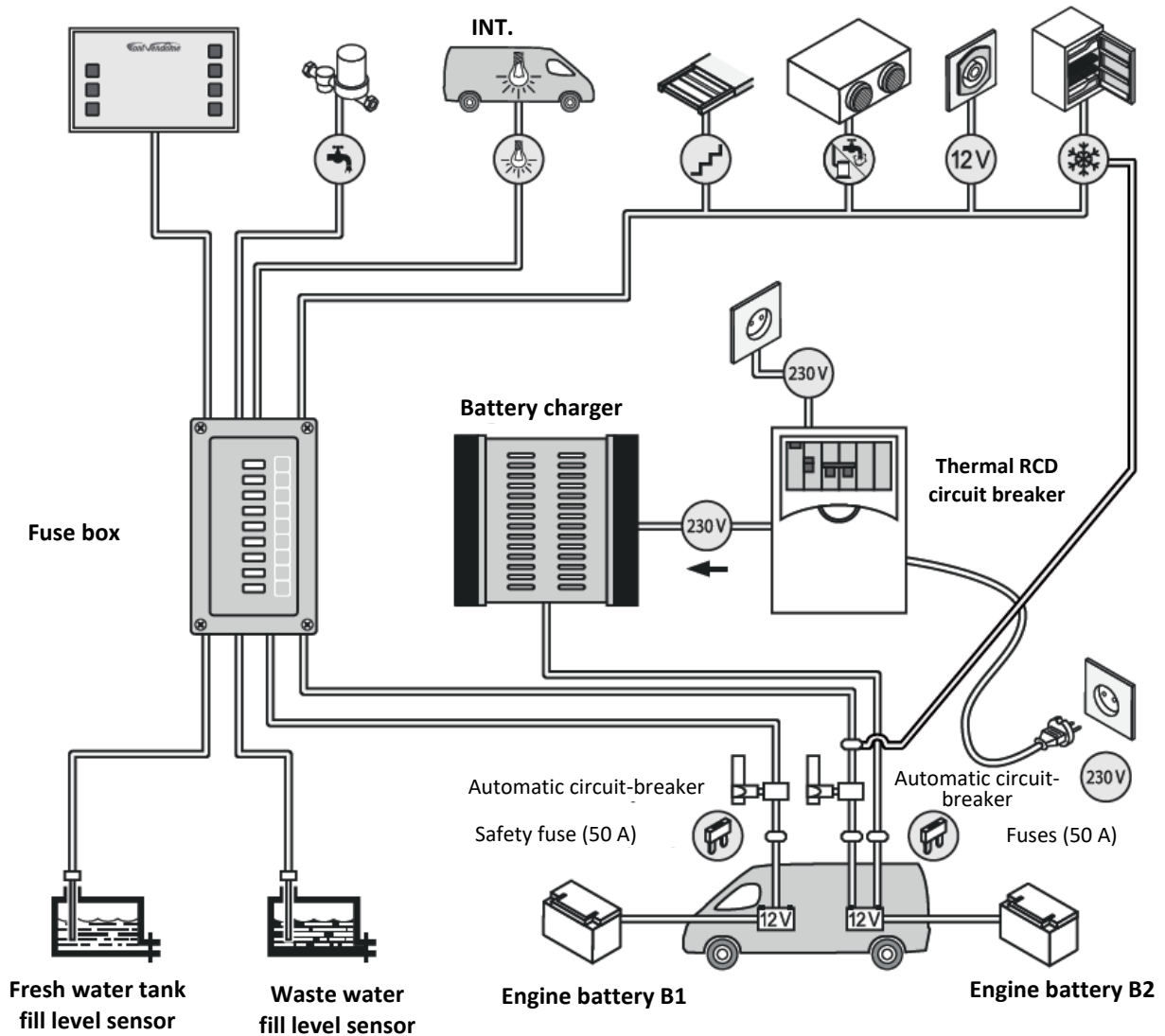

# 2 – System operation

It is the function of the electrical system to make your vehicle as autonomous as possible.

The energy required for operating the lights and all appliances in your living room is either provided by a 12 V battery or via a cable connected to the mains supply if the vehicle is parked (both the battery and the cable are not included in scope of delivery).

The electrical system consists of two separate electric circuits: 12 V and 230 V.

## 3 – Electric power supply 230 V

---

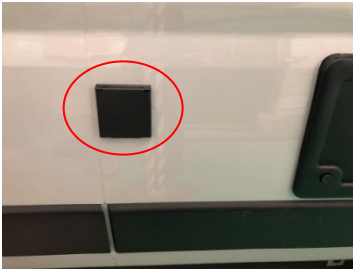

In order to supply your vehicle with 230 V, the vehicle must be connected via a standardised CEE-coupling on the left side of the vehicle.

It is recommended to use a three-core supply line with sufficient cross-section ( $3 \times 2.5 \text{ mm}^2$ ) and a length of max. 25 m.

This cable must be fitted with water-proof connecting couplings 230 V/16 A.

You must also make sure that the socket outlet to which the vehicle is to be connected is compatible.

The 230 V circuit supplies the refrigerator, the socket outlets and the battery charger.

These appliances are protected by a 230 V (16 A) thermal RCD circuit breaker which is located in the rear left box together with the fuse box and the battery charger.



## 4 – Electric power supply 12 V

---

The 12 V electric circuit consists of the following elements:

- **Engine battery**

It is located near the feet of the driver. It is directly charged by the engine generator.

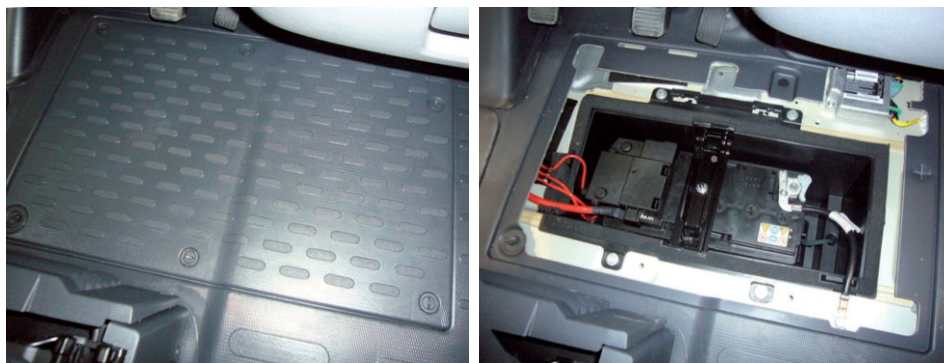

It supplies all basic functions of your vehicle (headlights, indicators, windscreen wipers etc.), but also certain appliances in the living room (refrigerator during travel).

- **Living room batteries**

The living room batteries are stored in the rear box on the right side. While the vehicle is in motion, the batteries are charged by the engine generator, or by the battery charger if the vehicle is connected to an external socket outlet.



These batteries supply all the appliances in the living room which are powered with 12 V voltage (lighting system, water pump, etc.).

- **Battery charger**

The battery charger is located in the rear box on the right side. It is used for charging the batteries. It runs permanently and converts the 230 V voltage to 12 V.



- **Distribution module**

This module can be found near the circuit breaker. It contains all fuses and distributes the power supply to all premises in the vehicle.

- **Fuse holder**

This module can be found under the distribution module. It contains fuses for the heater (diesel or gas), the refrigerator and the control panel for the heater / boiler.

- **Automatic circuit breakers**

The automatic circuit breakers can be found under the distribution module. The automatic circuit breaker B1 cuts off the living area cabin. The automatic circuit breaker B2 cuts off the supply of the living room.

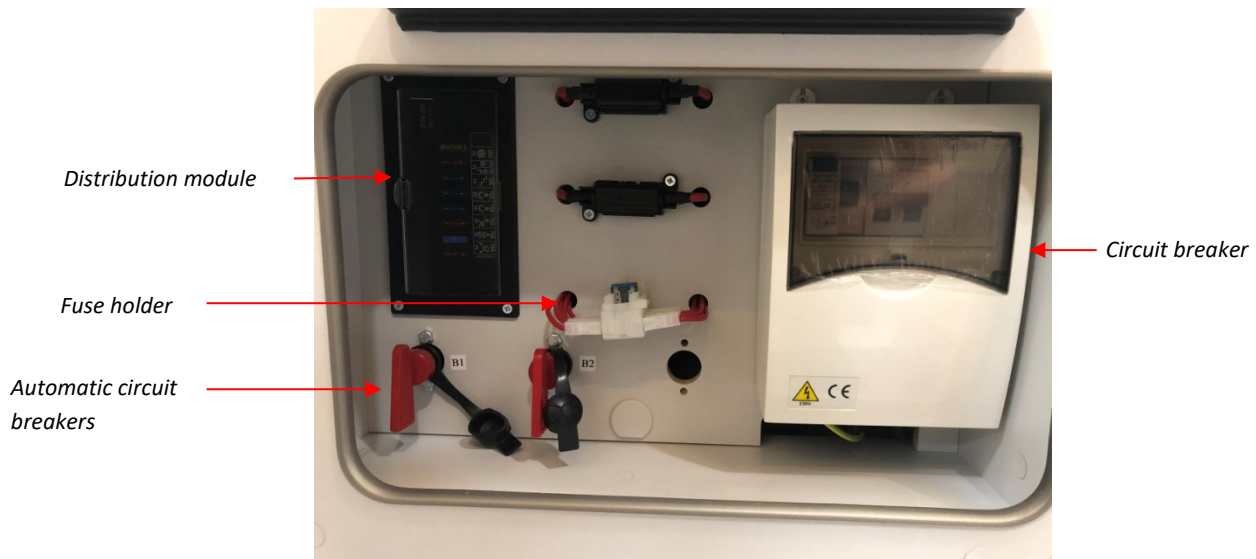

Make sure to turn off the heater on the control panel before disconnecting the living room batteries from the electrical circuit. None of the LEDs should be lit.

- **Control panel**

The control panel is mounted above the kitchen unit.

The control panel allows you to control various electric appliances in your vehicle and to check several parameters for the optimal use of the living room. The respective panel is a touch panel.



To switch on the panel, simply touch the screen for two seconds.

**On/Off button**

Switches the control panel on and off.

**Button for interior lighting**

This button is used to switch on the electric power supply for the interior lighting.

**Button for exterior lighting**

This button is used to switch on the electric power supply for the exterior lighting.

**Button for water pump**

Switches on the electric power supply for the water pump.

**Button for fresh water tank**

Shows the filling level in the fresh water tank in percent. The light flashes when the tank is empty. The filling level appears on the screen for approx. 30 seconds.

**Control light for waste water tank**

This light comes on when the waste water tank is full.

**Control light for battery charge via external cable / 230 V applied.**

Indicates that the living room batteries are being charged directly from the external connection of your vehicle by an external 230 V circuit.

**Control light for battery charge B2 (living room)**

Indicates that the battery B2 (living room) is currently being charged by battery B1 (engine) after the engine has been started.

**Button for battery B2 (living room) charge status**

Shows voltage and charge status of the living room battery. Press once to display the voltage, press again to view the charge status in percent. The charge level is displayed on the screen for approx. 30 seconds.

**Button for battery B1 (engine) charge status**

Shows voltage and charge status of the engine battery. Press once to display the voltage, press again to view the charge status in percent. The charge level appears on the screen for approx. 30 seconds.



If the voltage of the living room battery drops below 10 V, the control panel and all active appliances will be shut down within one minute.



A battery is considered discharged when the charge status shown on the control panel is less than 1/3. There is a risk of exhaustive/total discharge of the battery if the this charge limit is surpassed. In this case the battery is completely discharged and is thus no longer able to take up and maintain its full capacity. This results in a considerable decline in battery power and has a negative effect on the electric components, especially the distribution module.

**The Karmann-Mobil warranty does not apply in cases of exhaustive/total discharge.**



# 5 – Fuses 12 V

Open the plastic cover to gain access to the fuses. Close the cover again after the procedure.

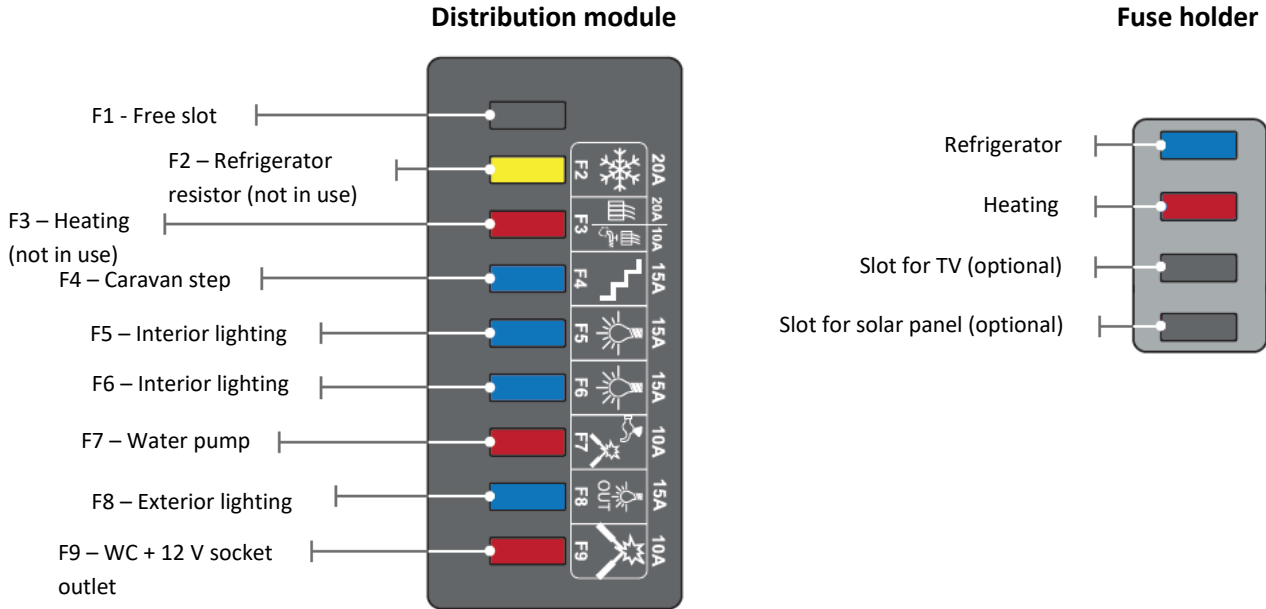

**Make sure that all appliances have been switched off before replacing a fuse. The replacement fuse must be of the same amperage. However, before replacing a fuse determine the root cause first, please.**



**Never replace a fuse with a metal object and never try to repair a fuse yourself.**



**Danger of injury or fire if these instructions are ignored.**



**If the problem can neither be solved by replacing the fuse nor by reactivating the circuit breaker, you should have the system checked by a certified specialist.**

# 6 – Electrical consumers

- **LED exterior lighting 12 V**

The exterior lighting is located on the right side of the vehicle, above the side entrance.



- LED interior lighting 12 V



LED spots



LED spots + luminous band on the cabinets



LED fixed-track strip

## 7 – Notes on safety

---

Connection to the mains supply must be made in compliance with applicable standards.

Do not smoke when working on the living room battery. Switch off all appliances and all lights.



**For safety reasons and to maintain the warranty, changes of the electrical system must only be made by authorised dealers with the written consent of Karmann-Mobil.**





# HEATING

# 1 – Ventilation circuit

---

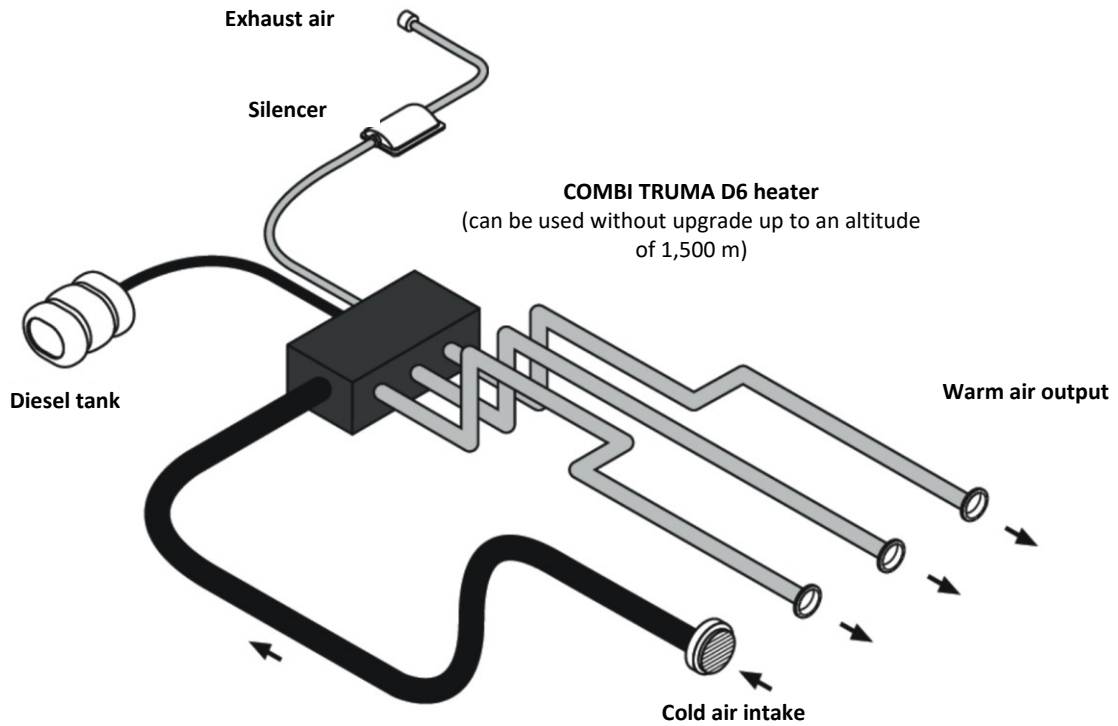

# 2 – Operation

---

The heater is installed in the rear box on the left side and is powered with diesel fuel. The heater takes the fuel directly from the fuel tank and warms the cold air drawn from the living room. Afterwards the warm air is distributed through air vents to various locations in the living room.



*Air vent for the warm air*



*Cold air intake grill*



Make sure that the air vents and intake grilles remain unobstructed.  
At least one of the air intake grilles of the vehicle should be without a flap.

The heating system is controlled by the control panel, which is located above the kitchen block.



- **Control panel**

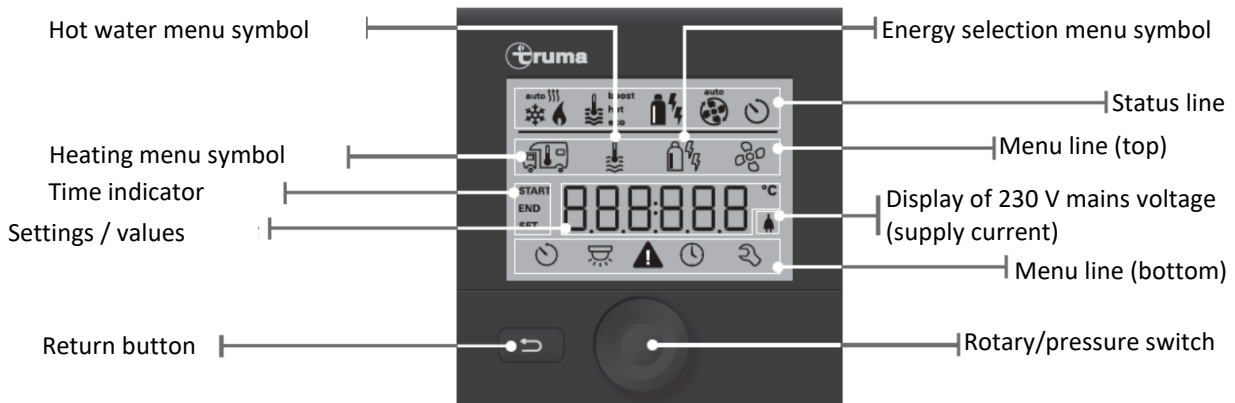

Different values and parameters can be selected, changed and stored with the rotary/pressure switch. The selected menu items flash.

- **Operating the heating system**

Turn the rotary/pressure switch to the right to scroll through the symbols of the upper menu until the heating symbol appears.  
Press the switch to confirm the selection. Turn the switch again to the right to select the desired temperature.

- **Operating the heating with hot water supply**

Turn the rotary/pressure switch to the right to scroll through the symbols of the upper menu until the heating symbol appears.  
Press the switch to confirm the selection, then select the hot water symbol and press the switch again to confirm the selection.

- **Faults**

In the event of a fault, the Truma CP+ controller immediately switches to the “Fault” menu and shows the error code of the fault. Refer to the manual of the Truma CP+ controller for information about troubleshooting and instructions for correction.

After the problem has been detected and corrected, reset the system by keeping the rotary/pressure switch pressed for at least four seconds to switch off the unit. Now turn on the unit again.



**During frost periods it is important to empty the boiler thoroughly. Frost damage is not covered by the warranty.**



Toilet



# 1 – Toilet installation

---

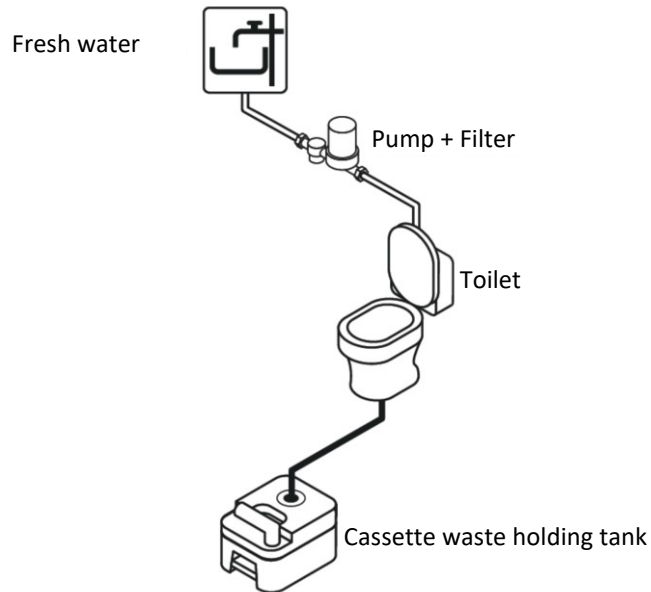

## 2 – Use

---

The toilet system in your vehicle consists of a toilet bowl with flushing and an emptying tank (cassette).

- **Toilet bowl**

The toilet bowl can be swivelled and is equipped with a folding seat and lid. There is a latch underneath the seat that lets you open a slider in order to empty the toilet bowl.



**Do not put the toilet cleaner directly into the toilet bowl.**



Button for toilet flushing

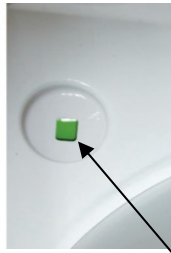

Indicator for the cassette fill level

The toilet bowl can be flushed after use by activating the flush button above the control panel behind the seat. The fill level of the cassette can be checked using the control light on the left side behind the toilet bowl.

Swivel the toilet bowl into a comfortable position before use. It is recommended to use the flush knob to allow water to flow into the toilet bowl. The water stops flowing as soon as the flush button is released.

After use, open the slider by turning the handle counter-clockwise. Use the flush key for flushing the bowl. Do not forget to close the slider again to avoid the spread of unpleasant odours.



Consider the air pressure when opening the door to the toilet cassette. Be sure to close the toilet lid before opening the slider.



The flush button also works when the cassette is not in its enclosure. Ensure that the toilet bowl is empty before each journey and that the slider and the toilet lid are closed.

- **Toilet cassette installation**

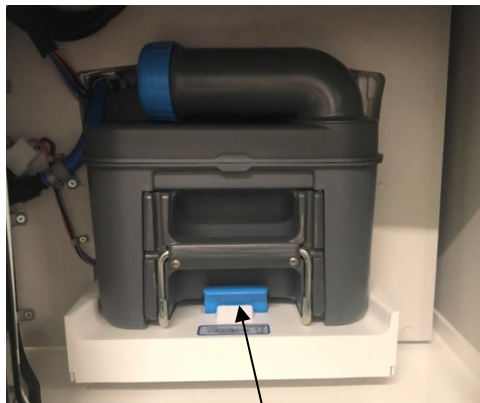
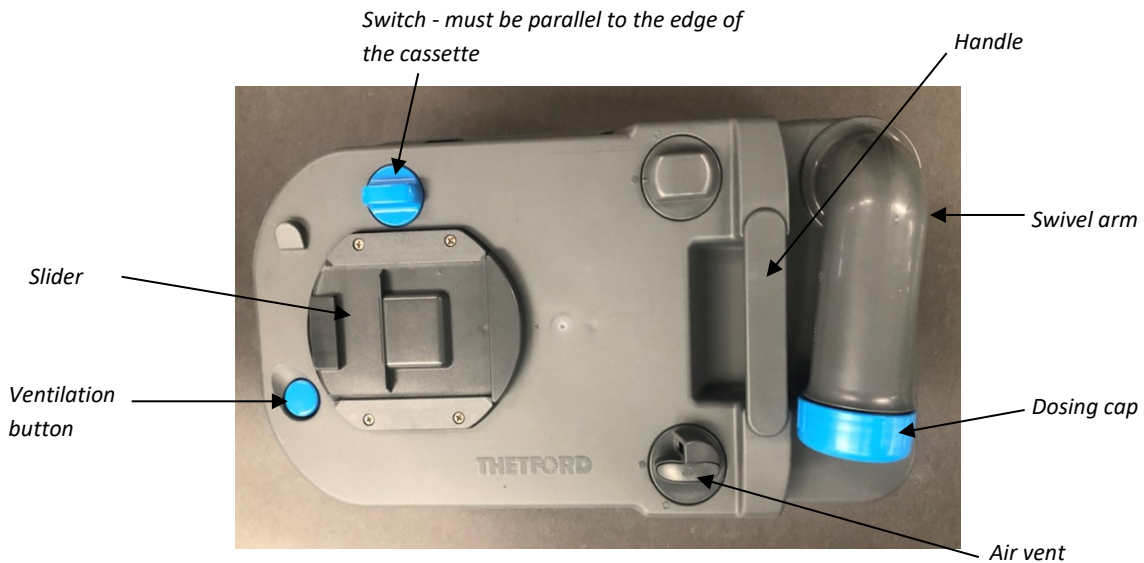

Locking latch

The cassette is accessible via a flap on the rear left side of vehicle.  
The cassette becomes visible when opening the rear door.

- Before you remove the cassette, make sure that the slider of the toilet bowl is firmly closed, then open the door by pressing both buttons.
- Lift up the locking latch and pull out the cassette as far as it will go. Keep the cassette horizontally. Tilt the cassette slightly and lift it out.
- Place the cassette in a vertical position. Rotate the swivel arm upwards. Remove the dosing cap from the swivel arm. Pour the amount of WC fluid prescribed by Thetford into the tube of the swivel arm.
- Subsequently, add sufficient water so that the bottom of the cassette is adequately covered (approx. 2 litres).



Note: In very warm weather or prolonged storage, more WC fluid may have to be used. For best results, use only fluids intended for Thetford toilets.

- Slide the cassette into the corresponding enclosure on the left side of the vehicle.
- Ensure that the cassette is locked in place before closing the door.



Careful when handling toilet cleaners!

- Wash hands after each use.
- In case of contact with eyes, rinse them with plenty of water.
- Keep out of reach of children.

- **Emptying the toilet cassette**

When the cassette is three quarter full, the colour of the control light on the control panel changes to red. In this case, the cassette should be emptied as soon as possible.

- Check and ensure that the slider is securely closed. Subsequently, take the cassette out of its enclosure.
- Place the cassette in a vertical position. Rotate the swivel arm upwards. Remove the dosing cap from the swivel arm.

- Pick up the cassette in such a way that you can press the ventilation button with your thumb while emptying the cassette. This will avoid splashing of the cassette content.
- Tilt the cassette over a suitable container. Rinse with clear water.

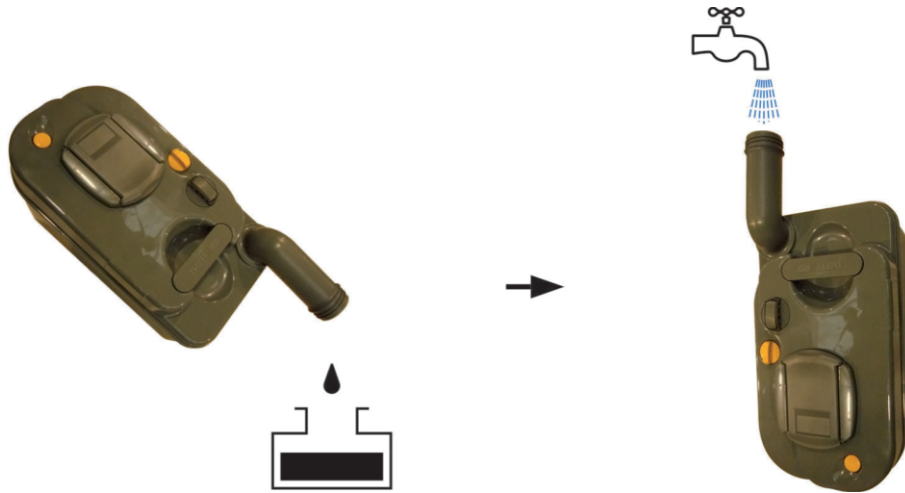

- After the cassette is emptied, reinsert the cassette into its enclosure.

## 3 – Cleaning and maintenance

---

Use mild soap or washing-up liquid to clean the toilet bowl, the seat and the lid as well as the outside of the toilet.

The rubber seal of the slider must be regularly maintained (once or twice a month, depending on use).

- Push the sliding plate in the direction of the swivel arm.
  - Open the slider by turning the handle counter-clockwise.
  - Clean the gasket with water.
- Dry the gasket, then moisten it with a lubricant from a spray can.



*Example (manufacturer's recommendation)*

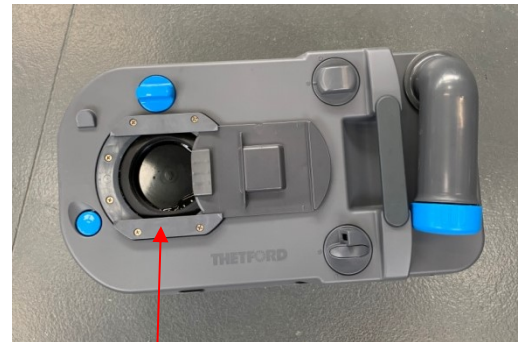

*Gasket*

Fill the cassette with water and rinse it thoroughly.



Never use cleaning agents containing chlorine, solvents or other corrosive components.





# ELECTRICAL HOUSEHOLD APPLIANCES



# 1 – Cooking hob

---

- **Using the cooking hob**

- In order to start and operate the cooking hob, open the main stopcock of the gas cylinder.



- Fold up the cover of the cooking hob before turning on the hob. The folded up cover can be secured with a hook on the side of the refrigerator.



On the cooking hob, turn the corresponding knob counter-clockwise from a closed position (symbol ●) to the maximum open position (large flame symbol).

- Press the knob and hold it in this position.

- Switch on the burner by pressing the electric igniter switch.

- Use the knob to adjust the desired intensity (large or small flame).

The ignition process must be completely visible, the view must not be obscured by other appliances or objects.



When using the cooking hob, you must open the nearby window to ensure a sufficient supply of fresh air. Additionally make sure that the protective cover is fastened correctly to the refrigerator to prevent damages.



The lower opening of the safety ventilation must never be covered, not even partially. The opening must be checked regularly and cleaned if necessary.



After having used the cooking hob, make sure that the knobs have been returned to position 0 and close the main stopcock on the gas cylinder, if no other gas-powered appliance is currently in use.

- **Care**

The grilles on the cooking hob can be removed for easier cleaning.

A conventional household cleaner is sufficient to clean the cooking hob. Avoid scouring agents.



Wait until the grilles have cooled down before you start cleaning.



Make sure that all burners are switched off before you fold down the cover.

## 2 – Refrigerator

Your vehicle is equipped with a compressor refrigerator made by **Thetford**. The refrigerator is designed to operate with 12 V DC.

The refrigerator allows you to store fresh food.  
You may also store frozen food in the freezer compartment.

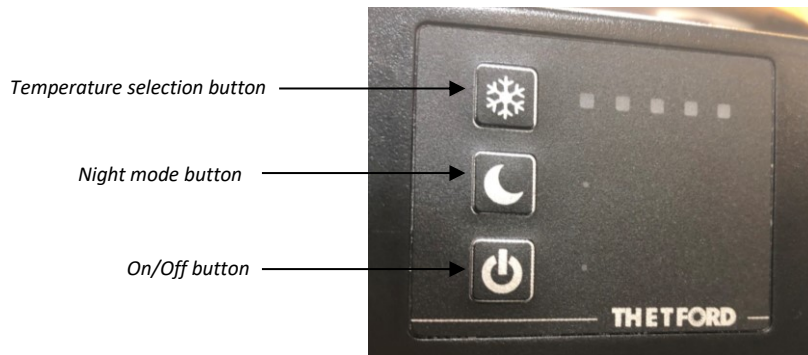

The cooling power depends on the ambient temperature, the amount of food to be kept cool and the number of times the refrigerator door is opened.

- **Food preservation**

- Turn the refrigerator on approx. 12 hours before filling it and, if possible, only fill it with food that has already been pre-cooled.
- Always keep food in closed containers or wrapped in aluminium foil or similar wrapping.
- Do not put hot or warm food in the refrigerator, wait until the food has cooled down.
- Never store food in the refrigerator which could emit volatile or ignitable gases.
- Delicate or perishable food must be placed directly next to the cooling elements.
- The freezer compartment is intended for ice-cream preparations and the short-term storage of frozen food. It is not suitable for freezing food.
- Protect the refrigerator from direct sunlight.
- Bear in mind that if the vehicle is parked in direct sunlight, the increased indoor temperature may adversely affect the power consumption and performance of the refrigerator.
- Always ensure unobstructed air circulation around the refrigerator.

- **Defrosting the cooling compartment**

Over time, frost builds up on the cooling fins. Once the ice layer has a thickness of approx. 3 mm, the refrigerator needs to be defrosted.

Condensation water is collected into a container. The container is located on the rear side of the refrigerator. The condensation water is left there to evaporate.



Drain opening of the container.

- **Defrosting the freezer compartment**

Take out the food and store it in another refrigerator, if available. Turn the temperature controller to level 0. Keep the door open.

Never use any mechanical tools or heat sources to remove the ice layers or to loosen objects that are or frozen in place.

- **Door lock**

The refrigerator has a locking device for the door, which serves as a protection while travelling.

The blue bracket on the handle can be placed in such a way (see the photo below) that the door stays slightly opened.



Position 1 (standard)

Position 2 (the door can not be closed completely)

- **Switching the refrigerator off**

- Switch off refrigerator
- Clean the inside of the refrigerator.
- Set the blue bracket in position 2
- Close the door so that it clicks into place.

The door remains slightly open to prevent the development of odours.

- **Care**

The refrigerator can be cleaned with a commercial domestic cleaning agent. Avoid scouring agents.

- **Tips on saving energy**

- At an average outside temperature of 25 °C, it is sufficient to set the temperature controller to an intermediate position.
- If possible, only place food in the refrigerator that has already been pre-cooled.
- Protect the refrigerator from direct sunlight.
- Unobstructed air circulation around the refrigerator is essential.





# OPENINGS



# 1 – Windows

---

- **Window adjustment devices**

The side windows of your vehicle are all equipped with adjustment devices that allow opening in two different positions.

To open the window, unlock the lever by turning it a quarter turn toward the left to the vertical position.



Position 1

Position 2

Push the window to the desired position. A clicking sound indicates each possible position.



Position 1

Position 2

To close the window, open the lever as far as it goes and then lower it.



Before closing the windows, check that the lock is not blocked by any objects.



Do not forget to close and lock all windows before setting the vehicle in motion or when leaving the vehicle.

- **Window activation switch**

The rear left window is fitted with an activation switch. If the window is open, the heater is switched off to make sure that the burnt gas—which is discharged through a grille below the window— does not enter the vehicle.



*Activation switch on the window*

## 2 – Skylights

- **Skylights in the living room**

The living room of your vehicle is equipped with two skylights above the different living areas.

In order to open the skylight, press the release button to unlock the bracket and pull the bracket down. Then pull the bracket towards you to lock it into one of the three opening positions.



Position 1

Position 2

Position 3

To close the skylight again, lift the bracket out of the opening, push it forward and slide it over the release button.

- **Bathroom skylight**

To open the skylight in the bathroom, turn the crank counter-clockwise. To close the skylight, turn the crank clockwise.

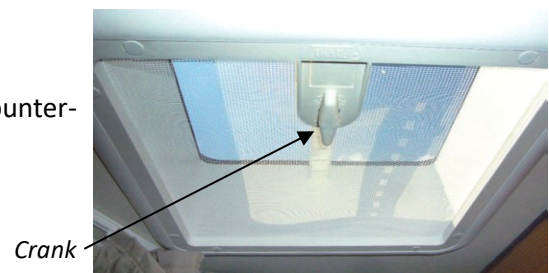

Do not forget to close and lock all skylights before setting the vehicle in motion or when leaving the vehicle.

Do not adjust the skylights while driving the vehicle.

# 3 – Blinds and insect screens

- **Blinds and insect screens on the window**

To close the blind, pull it up until it engages in the top lock. The insect screen is rolled and fixed in the reverse direction.



*Insect screen*

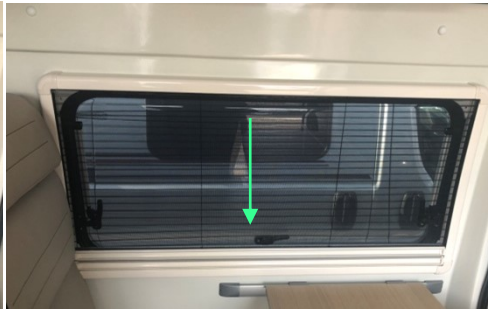

*Blinds*

- **Blinds and insect screens for skylights**

To close the blind of the skylight, place it in the desired position.

The procedure is the same as for the insect screen.



- **Insect screen at side door**

Roll up the insect screen to close it.



**It is recommended to use the handle when closing/opening the blind. It is strictly mandatory to first pull the insect screen before closing the side door.**

- **Windscreen blinds**

The windscreen blinds can be closed completely for a good night sleep.



First, unlatch the handles on each side by pressing into the notches and pull the handles towards the centre. Then connect the blinds in the middle of the windscreen. Both handles are equipped with magnets and can be connected to each other.

- **Cabins blinds**

The vehicle is also equipped with blinds to obscure the cabin windows.

To obscure the cabin windows, pull the handles on the right side of the window to pull out the folded blind. Snap the blind into the other side of the window.



For safety reasons (unobstructed view), the blinds must never be closed when the vehicle is in motion.

- **Obscuring the rear door**

The rear windows of your vehicle can be darkened with an opaque curtain.

In order to darken the rear windows, simply pull the curtain across the entire length of the guide.



The curtain can be fastened with push buttons.



- **Curtains**

The rear windows of your vehicle can be darkened with isothermal curtains.

## 4 – Storage space

---

- **Push buttons for opening and closing doors**





To open a door, press the push button until it clicks. The door lock opens when you release the push button.

The push button pops out and can now be used as a handle for opening the door.

To close the door, press the push button again until you can hear a click, and then release it.

The upper storage compartments in the living room can be opened with a handle.

To open the storage compartment, press the handle down and pull it out.



Before setting the vehicle in motion, always make sure that all doors (including cabinet doors) are properly closed to prevent doors from opening and objects from falling out while the vehicle is in motion.



# SHUT-DOWN IN WINTER



# 1 – Water



The water system must be drained completely to avoid the risk of mould formation or frost.

- **Draining fresh water**



Turn off the power at the control panel.

Open the fresh water drain valve.

Open all taps to ensure complete drainage.

To finish the draining process, start the pump and let it run for some time, keeping the taps open during this time.



*Fresh water drain valve*

- **Draining the waste water**



Before you start draining, clean the kitchen sink, the wash basin and the shower.

In order to drain the waste water tank, it is sufficient to pull the lever on the left side of the vehicle near the rear wheel.



*Handle to drain the waste water tank*



Waste water can only be drained at dedicated locations like roadside service areas, waste disposal stations or public and private sanitary facilities.

- **Draining the boiler**



Turn off the pump on the control panel and open all hot water taps.

Turn the rotary knob of the drain valve (Frost Control) by 90° until it clicks into place. The pressure switch is released from the engaged position and the drain valve opens.

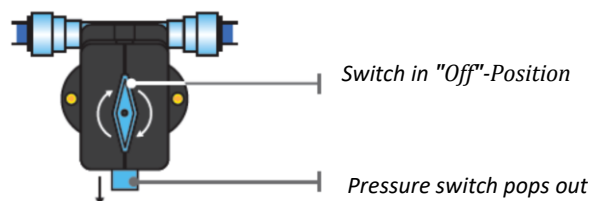

The water from the boiler is now drained outside via the drain valve. Place a container under the outlet to ensure that the boiler has been completely emptied (about 10 litres).

## 2 – Gas

---



Before the shut-down for a longer period of time, it is highly recommended to disconnect the gas cylinders and to store them in a well ventilated place.

Close the gas supply on the cylinder, disconnect the main stopcock and undo the fastening of the cylinders, so that you can take them out of their compartment.

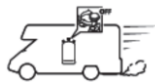

## 3 – Electric power

---

Before any shut-down for a longer period of time, check that all battery pole heads are clean. If there are signs of oxidation (white powder), clean the pole heads and apply contact grease.

Even after the vehicle has been shut down, it will still consume a residual amount of electric power. To prevent exhaustive/total discharge, it is necessary to

- either disconnect the batteries, if a connection to a 230 V electric power supply is not possible, and store them at room temperature. The batteries must be charged for 24 hours once a month.
- or store them in the vehicle if a connection to a 230 V electric power supply is possible. In this case, simply connect the vehicle to the electric power supply for 24 hours once a month to charge the batteries.



However, do not forget under any circumstances to switch off all electric appliances on the control panel before each step.



Never start the engine while the engine battery is disconnected. This would activate the anti-theft system.

In this case, the vehicle can only be started by your authorised dealer.

When disconnecting the battery, always start with the negative pole. This prevents a short-circuit when using a spanner to disconnect the battery.

To disconnect the battery, you must first press the button for the central locking system.

Press the button, then disconnect the ground terminal (negative pole) from the battery.

Take out the battery, then lock the vehicle manually with the key.



Central locking system

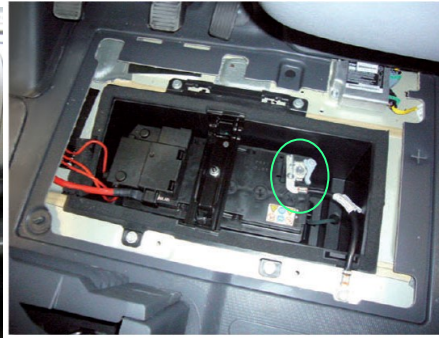

Ground terminal



## 4 – Toilet

---

- **Toilet bowl**

Use mild soap or washing-up liquid to clean the toilet bowl, the seat and the lid as well as the outside of the toilet.



Never use cleaning agents containing chlorine, solvents or other corrosive components.

- **Cassette**

When required, empty the cassette.

Use a hose to thoroughly rinse the cassette inside and outside.

Apply a 10 to 15% chlorine water solution or a non-foaming, perfume-free household disinfectant inside.

Lubricate the cassette by moistening it with a lubricant from a spray can (alternatively cooking oil can be used).

During the entire period the vehicle is shut down, remove the dispensing cap from the cassette to allow it to be aerated.

## 5 – Refrigerator

---

Empty the refrigerator completely.

Use the wedge to keep the door slightly open, so that no moisture can accumulate in the vehicle.

## 6 – Openings

---

Clean the windows and skylights in the living room with a commercially available washing-up liquid and plenty of water.

Apply talcum powder or silicone to all rubber pads.



Lubricate joints and hinges.



Never use abrasive means (sand paper, scouring pads, etc.) or alcohol-based cleaning agents.

Close the window and the skylights properly (do not close the blinds).

Take up cushions and mattresses and store them in a dry place.

Open all cabinet doors to vent all cabinets.



Throughout the shut-down period, make sure that all doors and windows are opened completely once per month for approx. 10 minutes to vent the interior of the vehicle and to prevent the generation of unpleasant odours and the formation of mould.

*Note:* If the vehicle is parked in a garage, you may leave one or several windows in a permanent ventilation position to ensure natural ventilation.





# CARE



# 1 – Wash room

---

All sanitary facilities must be cleaned regularly in order to avoid any risk of mould formation.

Use a damp sponge and washing-up liquid or soapy water for the wash basin, the shower cubicle and the toilet bowl.

Use a sponge and a stainless steel detergent for the kitchen sink.



Never use cleaning agents containing chlorine, solvents or other corrosive components.

# 2 – Electrical household appliances

---

- **Refrigerator**

Use a sponge and commercial domestic cleaning agent. Avoid scouring agents.

- **Cooking hob**

A conventional household cleaner is sufficient to clean the cooking hob. Avoid scouring agents.



Wait until the grilles have cooled down before you start cleaning.



Make sure that all burners are switched off before you fold down the cover.

## 3 – Openings

---

- **Window panes**

Clean the windows and skylights with a commercially available washing-up liquid.



Never use abrasive means (sand paper, scouring pads, etc.) or alcohol-based cleaning agents.

- **Seals and gaskets**

Clean seals and gaskets with a moist sponge and conventional washing up liquid. Thoroughly rinse and dry after cleaning. Apply talcum powder or silicone to all rubber seals/gaskets.

## 4 – Fabrics

---

- **Mattresses and upholstery**

Remove mattresses and upholstery regularly for airing them out to prevent any accumulation of moisture.

Remove the dust from the upholstery and the mattress outside the vehicle.



Do not use any aggressive petrol or acetone based stain removers but a more suitable product (test first on a less exposed area of the fabric).

Never wash cushions and mattresses with water.

- **Curtains**

Wash the curtains in the machine at 40°C. Do not use the spin cycle. Do not put the curtains in the dryer.

Do not iron.

Do not use any aggressive petrol or acetone based stain removers but a more suitable product (test first on a less exposed area of the fabric).



## 5 – Furnishings

---

Clean furniture with a dry, soft, antistatic dust cloth.

The hard-fibre table must be cleaned with a moist sponge and conventional detergent. Dry the hard-fibre table well after cleaning with a damp cloth.



Never use abrasive means (sand paper, knife, etc.). Use a clean sponge to avoid the formation of streaks.



## 6 – Exterior cleaning

---

Clean the vehicle body regularly with water and conventional washing up liquid; use a special sponge for bodywork and a suitable cloth. Rinse off with plenty of water after cleaning.



Do not wash your vehicle in a car wash with rotating washing cylinders as this may cause damage to the vehicle exterior.



# MISCELLANEOUS AND ACCESSORIES

# 1 – Bed in the living room

---

The front living room of your vehicle can be converted into a third sleeping area.

Fold the foot of the table by pressing the push button so that the table top is at the same height as the seat bench.

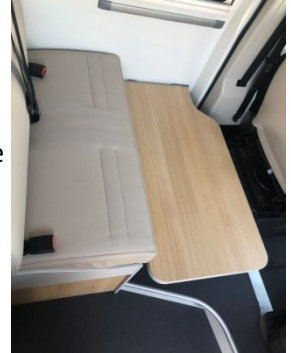

Grip the board between the both boxes, unfold the foot and secure the board between the bench and the kitchen block.

(The board is located in the back, because it can also be used as a ladder for the rear bed.)

The board can be easily secured to the ledge of the kitchen unit thanks to its holes.

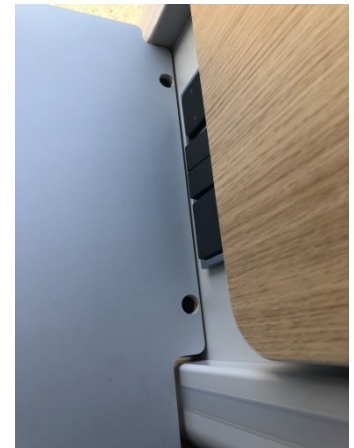

Put the cushions back so that they serve as a mattress.





## 2 – Table in living area

---

The table in the living room is removable and the support base allows incremental height adjustment. The table can be extended by adding a foldable element.

The support at the rear of the kitchen block allows the table from the living area to be set up outdoors.



## 3 – Caravan step

---

Your vehicle is equipped with an electric caravan step for easy access to the living room.

To extend the caravan step, press the left arrow of the key in the living room's entrance.

To retract the caravan step, press the right arrow. If you forget this, the caravan step will automatically retract when the vehicle's engine is started.





## 4 – Awning (optional)

---

To extend the awning, operate the hand crank.

Extend the two support legs and adjust the desired height of the awning using the locking mechanism in the respective detent.



Do not use the awning in a strong wind.



Do not forget to retract the awning before moving the vehicle.



Do not extend the awning for more than 0.5 m if the support legs are not in position yet due to the possible damage to the vehicle wall.

Use soapy water to clean the awning. Dry it well after the last use, or before it is not used for a long period.

## 5 – Bicycle carrier (optional)

---

To extend the bicycle carrier, pull the locking hooks aside.

The bicycle carrier can be securely fastened to the vehicle with various accessories which ensure safety during transportation.



The bicycle carrier is previewed exclusively for the transport of bicycles. Do not use it to carry luggage. Do not exceed the load capacity of the bicycle carrier (approx. 35 kg including the bike's own weight).



Do not attach more bicycles than there are support bars on the carrier.

## 6 – TV set (optional)

---

The flat screen TV set can be operated independently with 12 V or 230 V. Please follow the manufacturer's instructions regarding the connection. By an articulated arm which is attached to the side of the wardrobe the TV set can be set up to watch television from any location in the living room.



## 7 – USB connection

---

Your vehicle is equipped with a USB port. It is located on the left side of the cupboard above the seat bench.



## 8 – Thermal curtains

---

The rear windows of your vehicle can be darkened with isothermal curtains.

## 9 – Solar panel (optional)

---

By means of the solar panel you will be able to supply the vehicle with another energy source in addition to the 230 V supply.

## 10 – Altitude equipment (optional)

---

The altitude equipment allows to raise the supply pressure of the heater when travelling in high altitude areas. This way the switching off of the heater can be prevented.

## 11 – Heating sensor (optional)

---

Hanks to the heating sensor the formation of ice in the water tank can be prevented and the correspondend problems can be avoided.

## 12- Panorama roof window (Optional)

---

The panorama roof window allows to let more sunshine in the vehicle. If it is too bright inside, you can pull the blinds out of the frame.

# 13 – Notes on safety

---

Optional accessories are not included in the empty weight of your vehicle.

Therefore, accessories must be taken into account when loading and calculating the total weight of your vehicle.

Basic information:

- Awning: 30 kg
- Bicycle carriers (unloaded): 7.2 kg

All accessories may only be used for their intended purpose, otherwise there is a risk of an accident to occur.

The maximum loads in the stowage compartments must be strictly observed and loads must be distributed evenly.

Objects with a weight in excess of 20 kg must be tied down.

## Technical specifications

<b>ENGINE</b>	<b>2.3 Multijet 120CV</b>	<b>2.3 Multijet 140CV</b>	<b>2.3 Multijet 160CV</b>	<b>2.3 Multijet 180CV</b>
<i>Official services</i>	not specified	not specified	not specified	not specified
<i>Number of seats as per vehicle registration card</i>	4	4	4	4
<i>Number of sleeping areas</i>	3	3	3	3
<b>Dimensions</b>				
<i>Total length</i>	5,990	5,990	5,990	5,990
<i>Total width</i>	2050	2050	2050	2050
<i>Total height</i>	2,570	2,570	2,570	2,570
<b>WEIGHT</b>				
<i>Payload when ready for operation</i>	not specified	not specified	not specified	not specified
<i>GVW</i>	3500	3500	3500	3500



# Troubleshooting

The following list of possible faults which may potentially occur on different appliances in your vehicle and their causes is by no means complete.



If everything seems to be normal but the problem still persists, please contact the customer service of your authorised dealership.



**For safety reasons and to keep the warranty valid, any changes to the systems – in particular the water, gas and electric systems – must be carried out by your authorised dealer.**

## 1 – Water system

---

- **No water coming out of the taps.**

- The fresh water tank is empty.
- The pump has not been switched on (the control light on the control panel is off).
- Leave the stopcock open for a few seconds to allow air to escape, which may have got trapped in the water circuit.
- The drain valves are open.
- The boiler is empty.

- **The water does not drain from the kitchen sink, the wash basin or the shower.**

- The waste water tank is full.

- **The water drains from below the vehicle.**

- The fresh water tank is too full. Wait one minute until the excess water has drained.

- The fresh water tank drain valve is open.
- The waste water tank is full.
- The waste water tank drain valve is open.
- The drain valve of the boiler is open.

## 2 – Gas system

---

- **One or several gas-powered appliances do not work.**

- The gas supply of the cylinder is closed or separated.
- The gas cylinder is empty.
- Check the pressure gauge.

It is imperative that you check for a leak in the gas system. Gas that has escaped from the system can be recognised by its smell, or by applying soapy water to the connecting points. The formation of bubbles at these connections indicates a gas leak. Never use an open flame to check for a gas leak.

## 3 – Electrical system

---

- **One or several electrical appliances do not work.**

- The appliances are not in the “ON” position.
- Switch on the electric power supply on the control panel.
- The circuit breaker has responded.
- The fuse for the corresponding appliance must be replaced. Make sure you have switched the electric power supply off before changing a fuse.
- The contacts of the living room battery B2 are not correctly positioned.
- The contacts are covered with soot (sulphate present)
- Check the fuses; the automatic circuit breakers are located in the RL box.

## 4 – Heating system

---

- **The heater is not working**

- Replace the fuse.
- Check to ensure that sufficient fuel is available and/or that the temperature selected at the circuit breaker is not below the room temperature.
- Check that the intake port for cold air is not blocked.
- Make sure that the window with activation switch is correctly connected to the glass.



## 5 – Toilet

---

- **The slider does not work.**

- The cassette is full.
- The cassette is not correctly locked.

- **The toilet cannot be flushed.**

- The fresh water tank is empty.
- Pump is idling because air has accumulated in the system.
- The cassette is not correctly locked.
- The fuse in the enclosure of the toilet cassette or the fuse in the fuse box must be replaced.

**KARMANN**



**KARMANN**



**Model year 2020**